

SPECIFICATIONS

ARTICLE

Designation : **Multi-station trough washbasin**

Code bobet :

9772 : 2 basins, knee push | 9777 : 2 basins, electronic

9773 : 3 basins, knee push | 9778 : 3 basins, electronic

9774 : 4 basins, knee push | 9779 : 4 basins, electronic

9775 : 5 basins, knee push | 9780 : 5 basins, electronic

9776 : 6 basins, knee push | 9781 : 6 basins, electronic

Selling Unit : **Unit**

Non-contractual pictures

**MANUFACTURING :**

- Stainless steel AISI 1.4307 (304L), passivated finish
- Rectangular trough basin
- With splashback

Temporized water inlet :

- Either by a knee push valve
- Either by electronic control (automatic detection) - Power supply 200 volts single phase

- Standard wall mounted model
- Optional feet (Code Bobet 18618)
- Fit with a spout (length 120 mm) and a plug with strainer (40/49)
- Supplied with a siphon

OPTIONAL ACCESSORIES :

- Hot/cold water mixer
- Soap dispenser with push button
- Paper dispenser

ALIMENTARITY :

To ensure durability, our products are manufactured in austenitic stainless steel (food grade approved), standard AISI 1.4307 (304L).

Manufactured in our own Production Department under protected atmosphere and in accordance with the welding process "T.I.G".



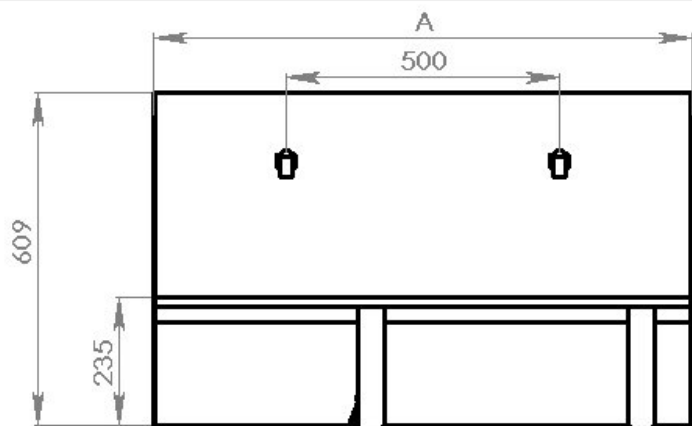

COMMANDE AUX GENOUX

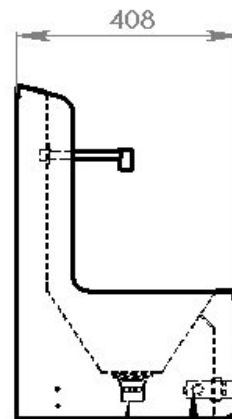
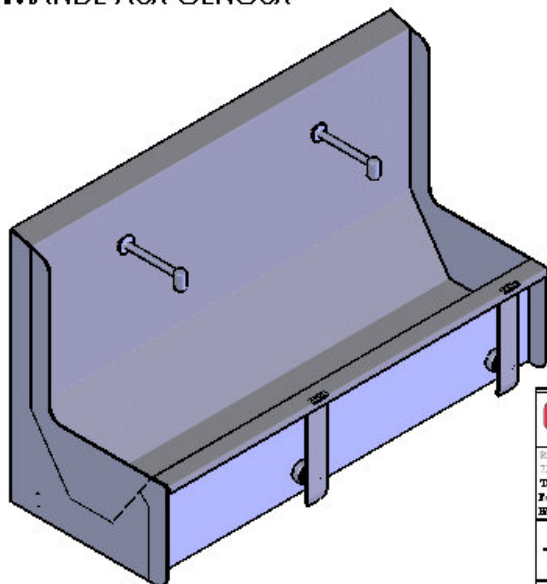

EVACUATION EN 40/49

ARRIVEE D'EAU EN 1/2 (15/21)

AUGES	A
2 POSTES	985
3 POSTES	1485
4 POSTES	1985
5 POSTES	2485
6 POSTES	2985

Ce document est la propriété exclusive de BOBET TECHNOLOGIE, il ne peut être reproduit sans autorisation écrite

BOBET
technologie

R.N.211 - Le ponton -
71 400 CHAMPAIGNE
Tél: 02 43 74 33 63
Fax: 02 43 74 33 76
Email: bobet@bobet-technologie.com

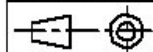

A4

Matière:	Caractéristiques :	Nb.:	Affaire:
Inox Z7 CN 18/09			
AUGE			OF.:
			Indice:
			Echelle: 1:10
			Date: 15/02/06
BOBET MATERIEL			Nom: RIBOT A.
			Poids: 3,47

C:\MATERIEL\Standard\220 Auge 2 postes

Dimensional datas are subject to change