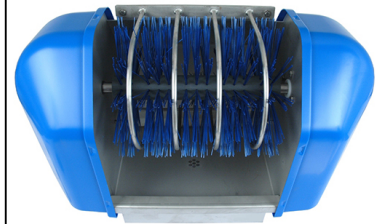
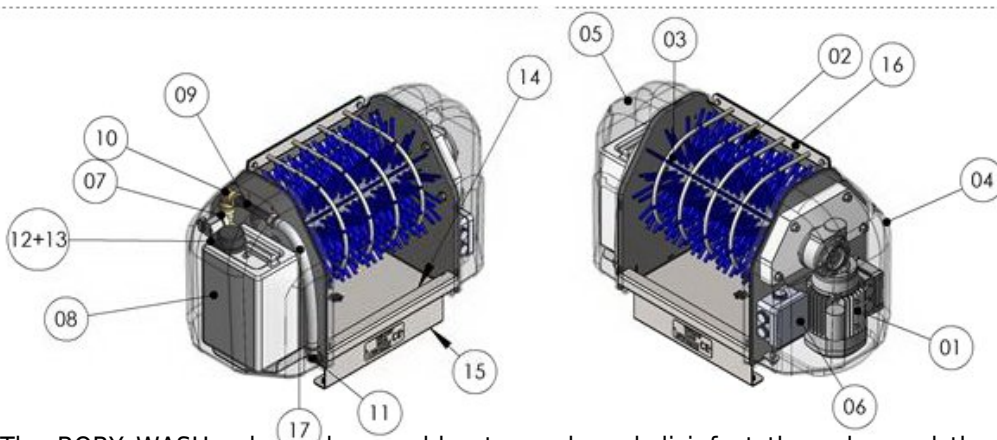

SPECIFICATIONS

ARTICLEDesignation : **BOBY WASH sole-washer**Code bobet : **18838**Selling Unit : **Unit**

Non-contractual pictures

**CHARACTERISTICS**

The BOBY WASH sole-washer enables to wash and disinfect the soles and the top of the boots or shoes. It is a complementary equipment which can be rapidly put everywhere necessary without going through the hygiene station. For example : outside the buildings, next to offices or maintenance department....

DIMENSIONS :

- Length 630 x width 300 x Height 410 mm
- Weight : 16 kg

ELECTRICAL CHARACTERISTICS :

- Voltage 230 V single phase + earth
- Frequency : 50 to 60 Hz
- Power : 60 W
- Protection index : IP 55
- Operated by electronic touch control
- Adjustable operating time : 30 s (factory setting), 45 s and 1 min

HYDRAULIC CHARACTERISTICS :

- Water consumption : 2 l/mm
- Maximum temperature : 50°C
- Minimum/Maximum pressure : 2 bars/5 bars
- Regular dosing of the disinfectant product*: 2%
- Capacity of the disinfectant product : 3 liters

* Using a 2% solution (factory setting) and an average operating time of 30 seconds per person, the container holds enough liquid for around 150 passages.

OTHER CHARACTERISTICS :

- Stainless steel frame, recycled ABS body
- Colour : blue
- Noise level : 55dB
- Water supply : standard hose (same as a washing machine)
- Evacuation : plug diameter 25 mm

The BOBY WASH is delivered with :

- A 3 liter empty container
- A 3 meter electrical connection with a male plug rated at 230 V + earth
- A 1.5-meter water link hose fit with F 3/4 (20x27) link
- A 1'1/2 plug (40x49) with a flexible outlet 0.5 m long with an outer diameter of 25 mm
- A manual of instruction

APPLICATION :

- Food industry : maintenance, veterinaries, small output...
- Agriculture : feeding, milking...
- Industries : maintenance...
- Building sites
- Catering, communities, hospital
- Leisures : hiking, hunting, fishing...
- Sport : football, golf, tennis...

ADVICE FOR USE

- Users should follow the instructions for use
- This device is only for use in cleaning the soles of footwear. Any other use of the device is non-standard
- For safety reasons, children must not use this device unless accompanied by an adult
- If the device is to be used with water, it must be kept out of freezing conditions
- To clean a sole that has been heavily soiled with mud, first pass the sole directly over the nozzles, so as to wet the mud before brushing
- The use of any detergent must be subject to informations for the user being made aware of any risks linked to the use of the detergent
- Placing a duckboard or an anti-slip mat in front of the device may help prevent slipping

STANDARDS :

In compliance with the EC standards

ALIMENTARITY :

To ensure durability, our products are manufactured in austenitic stainless steel (food grade approved), standard AISI 1.4307 (304L).

| Rep. () | Designation () | Quantity () | Code Bobet () |
|---------|----------------------------------|-----------------|------------------|
| 01 | Motor gear | 1 | 18841 |
| 02 | Brush | 1 | 21753 |
| 03 | Clip bushing-left hand | 1 | 18847 |
| 04 | casing - right hand | 1 | 18856 |
| 05 | casing - left hand | 1 | 18855 |
| 06 | Electronic card contact | 1 | 18846 |
| 08 | Container 3 litres | 1 | 18872 |
| 09 | Venturi M 283 | 1 | 14866 |
| 10 | Bushing 1/2" | 2 | 70106 |
| 11 | Grooved L-shaped connector 16x16 | 2 | 18857 |
| 12 | Supply tube | 1 | 18860 |
| 13 | Flexible supply connector | 2 | 18859 |
| 14 | Mini jet nozzle 180° | 2 | 13046 |
| 15 | Support P20 | 4 | 18215 |
| 16 | Grid | 1 | 18848 |
| 17 | Flexible Lg 300 | 1 | 1127 |

IND

Dimensional datas are subject to change