

SPECIFICATIONS

ARTICLE

Designation : **Boulangé detectable scoring knife**

Code bobet : **25106**

Selling Unit : **Unit**

Non-contractual pictures

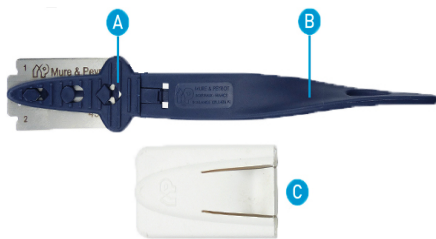
**CHARACTERISTICS**

A : Support de lame et changement de lame
B : Manche incurvé
C : Capuchon de protection



- Ergonomic handle
- Ambidextrous
- Detectable
- For a curved scoring of breads
- The shape enables each one to adapt the handle to his/her working method
- The blade can be changed easily and its 4 corners can be used
- Supplied with blade and protective cap
- Weight: 9 g
- Size: 150x22x15mm
- Spare blade (x10): Bobet code 25107
- Stainless steel blade
- Hardness: 58-59 HRC

STANDARDS :

Complies with EU Regulation 10/2011 relating to plastic materials in contact with foodstuffs.

